

www.tpqtools.com

### SIMPLE, EASY AND SAFE PULLING JOB

Equipped with Fast-acting Jaws, Powerram's unique patented Easy Pullers are dedicated for the absolute user-friendly and safe dismounting job in the market today. The most simple and efficient design - fast acting Jaws bring the users to position the puller on the part quickly and correctly by one man operating as well.

### USER-CONVENIENTLY:

- Absolutely user-conveniently raised from fast-acting and self-positioning jaws, locking on the part with just one man operating only.
- 360° Swivel connecting adaptor minimizes the space limited for connecting with the separate hydraulic pump.
- Spring loaded live centring nut for easily positioning without missing ( removable ).
- Optional hydraulic force are available from 4 Ton to 30 Ton versions.
- Light Aluminum hand pump provides the carrying convenience to the end users.
- Attached extension rods allow the user to extend the stroke according to the needs.

### SAFE:

- The Hydraulic pump equipped with the safety valve and pressure gauge is designed to prevent the overload to the puller.
- The built-in safety valve prevents any injury and damage to the user and/or the puller.
- Self-locking jaws eliminate the puller jaw slipping off under loading and/or hydraulic force releasing.

### COST SAVING:

- The built-in safety valve keeps away from the overloading always to ensure all spare parts working normally.
- Self-positioning & centring prevent the damage to the shaft as well.
- Service life of puller is prolonged by the built-in safety valve.
- Conveniently positioning, efficiently pulling cause much save on manpower and operating time.

B1128

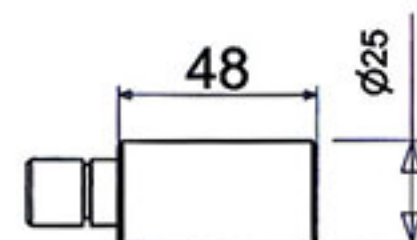

Extension Rod for 4, 6, 8 & 12 Tons Pullers

B1129

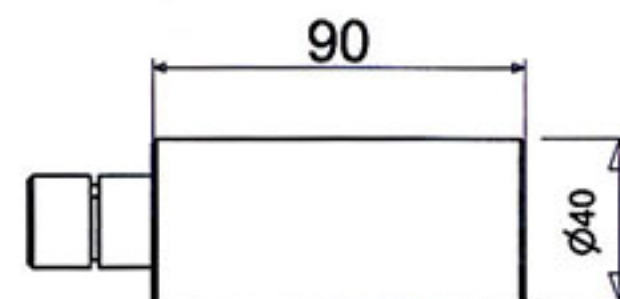

Extension Rod for 20 & 30 Tons Pullers

### TECHNICAL DATA

| Capacity | Model No. | Reach (Max. mm) | Spread (Max. mm) | Stroke (mm) |  | Pump Tip (mm) |    |    | Jaw Tip (mm) |      |      | Weight (kg) |
|----------|-----------|-----------------|------------------|-------------|--|---------------|----|----|--------------|------|------|-------------|
|          |           |                 |                  | H           |  | E             | F  | G  | A            | B    | C    |             |
| 4 Ton    | PRE400    | 190             | 315              | 60          |  | 42            | 22 | 40 | 13           | 10   | 22   | 5.6         |
| 8 Ton    | PRE800    | 280             | 460              | 85          |  | 50            | 25 | 70 | 13           | 13   | 27.5 | 9.0         |
| 12 Ton   | PRE1200   | 300             | 515              | 85          |  | 60            | 28 | 70 | 15           | 16.5 | 29   | 11.7        |
| 20 Ton   | PRE2000   | 325             | 520              | 111         |  | 80            | 40 | 62 | 20           | 27   | 33   | 24.0        |
| 30 Ton   | PRE3000   | 415             | 620              | 111         |  | 98            | 50 | 85 | 20           | 27   | 38   | 34.0        |

Patented in USA, Germany, Taiwan, P.R.C.....etc.